

**Multi-purpose,
industrial & commercial
lighting hardware,
developed for application in
warehouses, factories, workshops,
& production areas**

**100W-180W series power range
- Impact, ingress, & corrosion
resistant fitting - >130lm/W family
efficacy - 2no. general purpose &
task-specific optics - Superior glare
control through recessed light
engine & optional diffusers - Plug-
&-play intelligent control sensor**

**CE, RoHS, DLC, & cETLus
international product marks**



High Bay Lights



Mounting Options

Eye Bolt, universal bracket



Optional Fitting Colours

Black, custom (subject to MOQ)

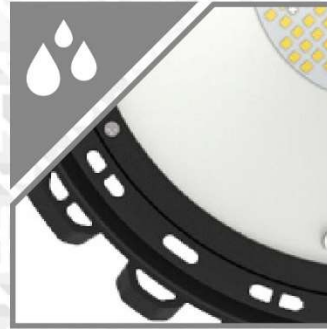

Environmental Protection

IP65 c/w corrosion-resistant powder coat, 304 stainless steel exposed fixtures



Impact Protection

IK08 rated

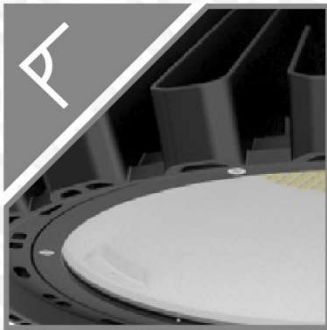

Distribution

2no. optic variants are available for general & task-specific applications



Horizontal Glare Reduction

65mm recessed light source significantly reduces horizontal glare, compared to flush-mounted market alternatives



Vertical Glare Reduction

Frosted, opal - Reduced-glare polycarbonate diffusers

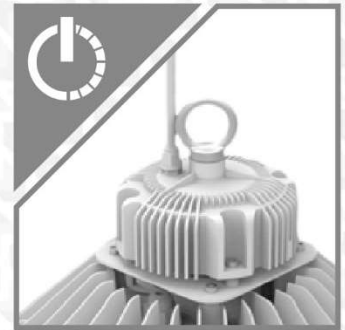

Driver Protocols

Non-dimming, 0-10V, 1-10V, DALI



Sensor(s)

Integrated (see 'Plug-&Play'), standalone (single or multiple luminaires per sensor options)



Integrated 'Plug-&Play' Sensor

Occupancy, multi-step dimming - System counterbalanced & rotation-resistant



Sensor Functions

Occupancy, multi-step dimming, photocell, daylight harvesting

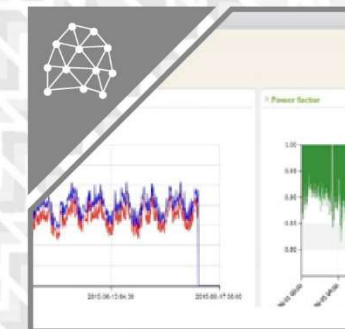

Advanced Controls

System energy reporting, data monitoring, IoT (wireless/wired) networks

Please note - images shown are intended to be illustrative only. For exact data, please refer to specific product photometry, available for download from our website.

Indicative Product Photometry

90° Optic

ISOLUX DIAGRAM

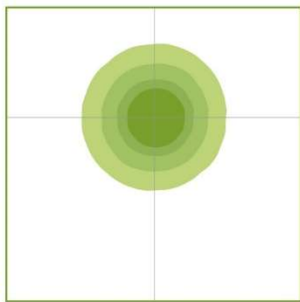

POLAR DIAGRAM

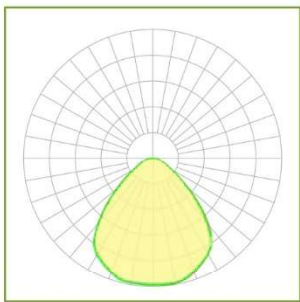

120° Optic

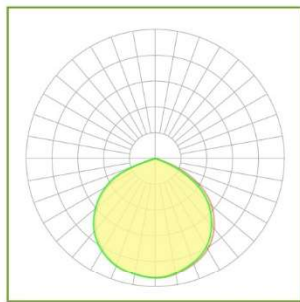
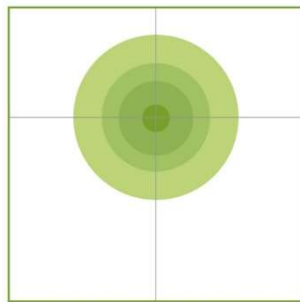

Diffusers

This series is available with the following diffusers. Each diffuser will have a varying effect on photometric distribution and intensity. Please refer to downloadable photometrics for exact data.



Clear Optic (Various Beam Angles)



Frosted Diffuser



Opal Diffuser

Exploded View

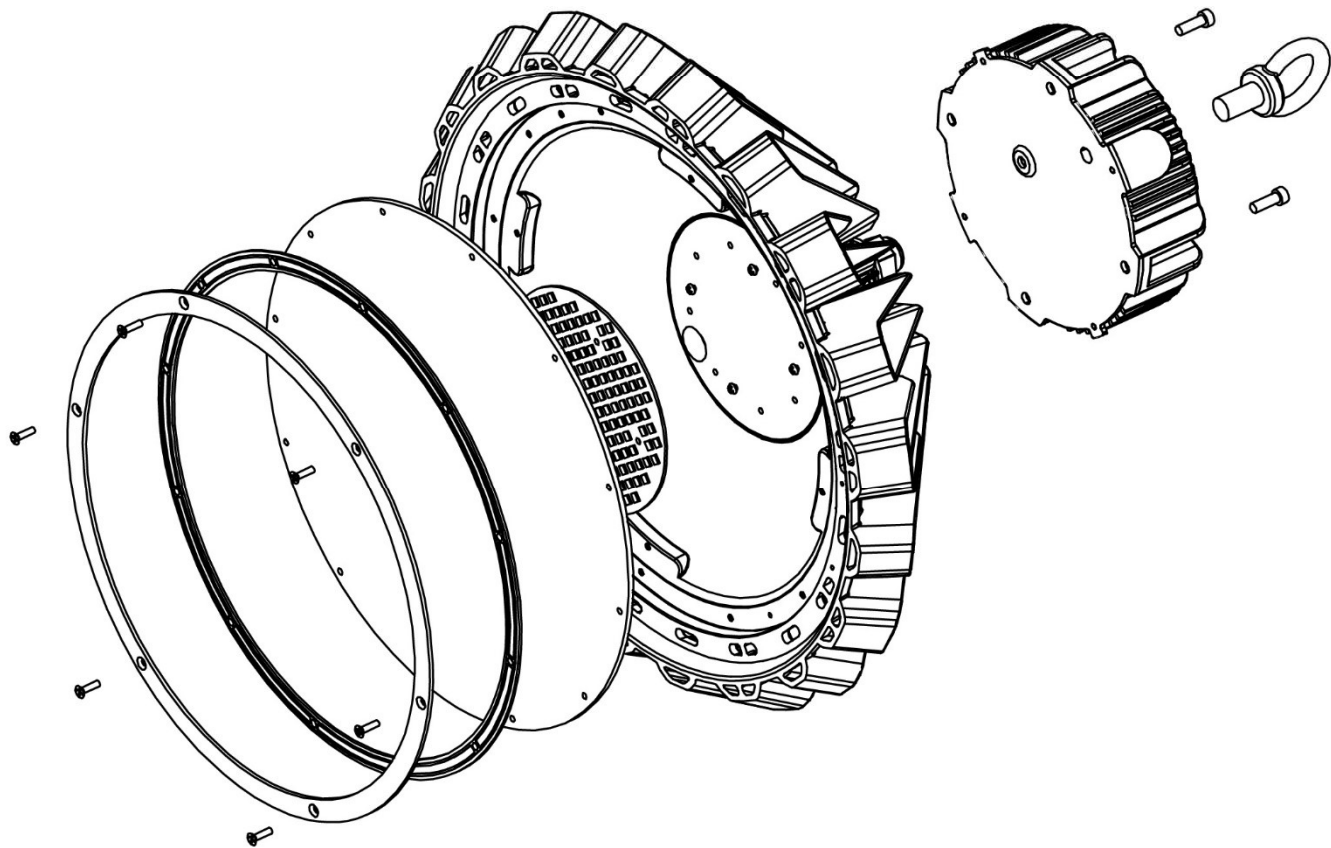



Nominal Power / Product Class	100W	120W	150W	180W
Nominal Efficacy	135lm/W	136lm/W	133lm/W	132lm/W
Nominal Output	13,500lm	16,320lm	19,950lm	23,750lm
Light Engine & Model	Nichia 2W757GRTV1	Nichia 2W757GRTV1	Nichia 2W757GRTV1	Nichia 2W757GRTV1
Lumen Maintenance (TM21)	L70 ≥100,000Hrs	L70 ≥100,000Hrs	L70 ≥100,000Hrs	L70 ≥100,000Hrs
LM79 Test Conditions (Abrid.)	Maintained 25°C	Maintained 25°C	Maintained 25°C	Maintained 25°C
CCT	5000K, Custom	5000K, Custom	5000K, Custom	5000K, Custom
CRI	≥70Ra, ≥80Ra	≥70Ra, ≥80Ra	≥70Ra, ≥80Ra	≥70Ra, ≥80Ra
UGR	Contact Office	Contact Office	Contact Office	Contact Office
Lens(es)	Clear, Milky, Frosted	Clear, Milky, Frosted	Clear, Milky, Frosted	Clear, Milky, Frosted
Symmetric Distribution	90°, <u>120°</u>	90°, <u>120°</u>	90°, <u>120°</u>	90°, <u>120°</u>
Asymmetric Distribution	Symmetric Only	Symmetric Only	Symmetric Only	Symmetric Only
Ingress Rating	IP65	IP65	IP65	IP65
Impact Resistance	IK08	IK08	IK08	IK08
Ambient Usage Tolerance	-30°C to 50°C	-30°C to 50°C	-30°C to 50°C	-30°C to 40°C
Ambient Storage Tolerance	-40°C to 65°C	-40°C to 65°C	-40°C to 65°C	-40°C to 65°C
Ambient Humidity Tolerance	15% to 90% RH	15% to 90% RH	15% to 90% RH	15% to 90% RH
PSU Manufacturer	Mean Well	Mean Well	Mean Well	Mean Well
PSU Advanced Data	Contact Office	Contact Office	Contact Office	Contact Office
Input Voltage	100-277VAC	100-277VAC	100-277VAC	100-277VAC
Input Frequency	47-63Hz	47-63Hz	47-63Hz	47-63Hz
Power Factor	≥0.95	≥0.95	≥0.95	≥0.95
THD	<15%	<15%	<15%	<15%
Product Dimensions (LxWxH)	360 x 230mm	360 x 230mm	360 x 230mm	360 x 230mm
Cable Dimensions (L)	1500mm	1500mm	1500mm	1500mm
Fixture Weight	5.8kg	5.8kg	6.0kg	6.6kg
Fixture Primary Materials	Aluminium Alloy	Aluminium Alloy	Aluminium Alloy	Aluminium Alloy
Fixture Finish	Powder Coated	Powder Coated	Powder Coated	Powder Coated
Lens(es) Materials	Polycarbonate	Polycarbonate	Polycarbonate	Polycarbonate
Product Warranty	5 Years	5 Years	5 Years	5 Years